



Health and safety

Please read these instructions carefully before using your Mico Toastie.

- Not suitable for conventional ovens or hobs/grills or combination microwave ovens.
- Ensure caution is taken when removing cookware from the microwave oven as it may be hot.
- Allow metals parts to cool before removing.
- Ensure metal parts are correctly fitted into moulded housing with no exposure, to prevent sparks occurring during cooking in microwave oven.
- Do not use repeatedly more than 4 times, allow to cool for 30 minutes.
- Not for commercial use. Household use only.

Your 1 year guarantee

Guarantee only available in the UK and Ireland. It is important to retain the retailer's receipt as proof of purchase. All Morphy Richards products are individually tested before leaving the factory. In the unlikely event of any appliance proving to be faulty within 28 days of purchase, it should be returned to the place of purchase for it to be replaced. If the fault develops after 28 days and within 12 months of original purchase, you should contact the Helpline number quoting Model number and Serial number on the product, or write to Morphy Richards at the address shown. You may be asked to return a copy of proof of purchase. Subject to exclusions, the faulty appliance will then be repaired or replaced as appropriate and dispatched usually within 7 working days of receipt. If, for any reason, this item is replaced or repaired during the 1 year guarantee period, the guarantee on the new item will be calculated from original purchase date. Therefore it is vital to retain your original till receipt or invoice to indicate the date of initial purchase. To qualify for the guarantee, the appliance must have been used according to the instructions supplied.

Cleaning and Care

Cleaning your Mico Toastie after each use will prolong its life.

- Fully disassemble your Mico Toastie to enable thorough cleaning (see overleaf for assembly instructions).
- All parts are dishwasher safe.
- If hand washing, do so in warm soapy water with a soft cloth to protect the non-stick coating on metal parts. Do not use scouring pads or abrasive chemicals.
- Do not use metal utensils when removing food from your Mico Toastie. Metal utensils may damage the non-stick coating on metal parts.
- Clean thoroughly before first use.

Contact Us

If you are having a problem with your appliance, please call our Helpline, as we are more likely to be able to help than the store you purchased the item from.

Please have the product name, model number and serial number to hand when you call to help us deal with your enquiry quicker:

UK: 0344 871 0944 | **EIRE:** 1800 409 119 | **SPARES:** 0344 873 0710

POSTAL: The After Sales Division, Morphy Richards Ltd
Mexborough, South Yorkshire, England, S64 8AJ

Talk To Us

If you have any questions or comments, or want some great tips or recipe ideas to help you get the most out of your products, join us online:

Blog: www.morphyrichards.co.uk/blog/

Facebook: [morphyrichardsuk](https://www.facebook.com/morphyrichardsuk)

Twitter: [@loveyourmorphy](https://twitter.com/loveyourmorphy)

Instagram: [morphyrichardsuk](https://www.instagram.com/morphyrichardsuk)

Website: www.morphyrichards.com



Discover the rest of the innovative **Mico** range
at www.morphyrichards.com

morphy richards®

mico TOASTIE 
microwave cookware

The **new** method
in your Microwave





Product overview

- 1 Outercasing**
- 2 Silicone shell**
- 3 Grill plates**
Coated in Heatwave Technology, fitted together they cook toasties like a conventional grill.
- 4 Outercasing clips**
Use to seal the two outercasings together during use.

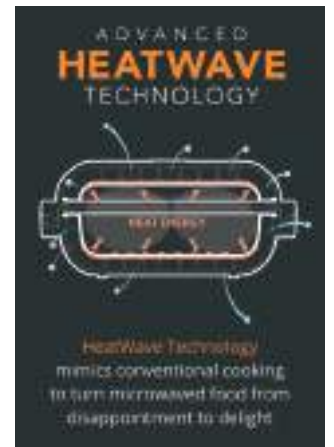

Assembly instructions

- 1** Align the arrow markers on the metal grill plates with the A & B markers on the silicone shells (1 arrow to A, 1 arrow to B). Securely fit the metal grill plates into the silicone shells.
- 2** Securely fit the silicone shells into the outercasings.
- 3** Push both assembled sections together.
- 4** Align the clips on both the upper and lower assembled sections together. Clip into place.

Disassembly instructions

- 1** Unclip the clips and lift off the top assembled section.
- 2** Turn both assembled sections so the metal grills are facing upwards.
- 3** Using thumbs, push the silicone shells out of outercasings.
- 4** Lift the metal grill plates out of the silicone shells.

How to use

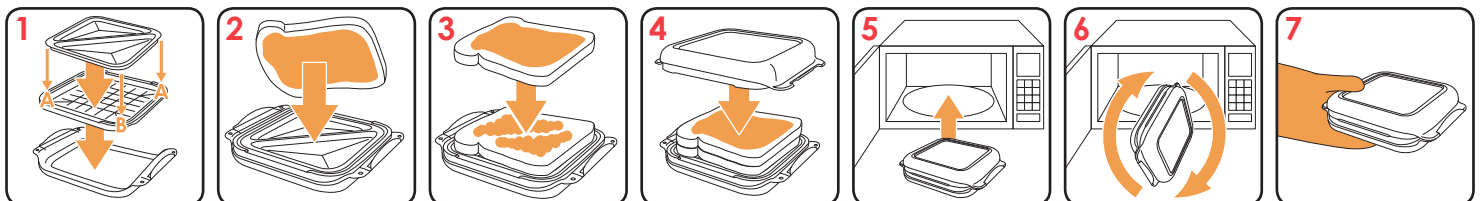

1 Assemble your Mico Toastie (ensuring hot plates are aligned).

2 Butter outside of bread and place on bottom plate. For best results, use bread specially made for toasting.

3 Add ingredients onto bread (with ingredients 1cm in from the edge). Add top slice of bread with butter facing upwards.

4 With clips on the lower assembly compress top assembly down and pull the clips upwards until they 'lock'.

5 Place in microwave oven on a microwavable plate. Enter correct cooking time and start.

6 Flip your Mico Toastie midway through cooking.

7 Remove with oven gloves. Unclip both sides and serve.

Microwave oven times

- Max 1200W microwave oven.
- Microwave oven times may vary.
- For repeated use, reduce cooking times by 15 seconds.
- Do not use repeatedly more than 4 times, allow to cool for 30 minutes.
- Timings may be adjusted to suit your personal tastes.

Microwave oven power	Light browning	Medium browning	High browning
1000W - 1200W	1 min 45 secs + 1 min 45 secs	2 mins 15 secs + 2 mins 15 secs	2 mins 45 secs + 2 mins 45 secs
900W - 1000W	1 min 45 secs + 1 min 45 secs	2 mins 15 secs + 2 mins 15 secs	2 mins 45 secs + 2 mins 45 secs
800W - 900W	2 mins + 2 mins	2 mins 30 secs + 2 mins 30 secs	3 mins + 3 mins